

Tecsis - Industrial pressure gauge Ø100 mm and Ø160 mm



- Robust construction
- Connection down/back
- Housing in stainless steel



Range of applications

Gauge intended for applications in demanding environments with media such as air, neutral gases, water or other media compatible with brass. Large easy to read scale.

Technical specification

Size	Ø100 mm and Ø160 mm
Max. deviation	±1.0% of maximum scale value as per EN837-1
Measurement system	Bourdon tube
Connection	G1/2"
Mechanism	Brass
Housing	Stainless steel SS2333
Wetted parts	Copper alloy
Media temperature	-20 °C to +80 °C
Temperature deviation	0.3 %/10K from +20 °C
Ambient temperature	-25 °C to +60 °C
Glass	Instrument glass
Max. working pressure	90% of the scale with changing load 100% of the scale with constant load
Overpressure protection	End value can be temporarily exceeded by 30 %
Scale	Calibration in bar
IP-class	IP54 according to EN60529/IEC529
Weight	0.6-1 kg

Dimensions

Model P1533

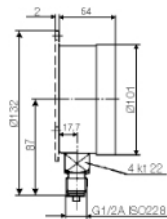

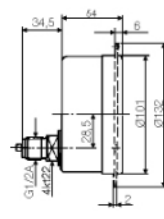

Model P1534

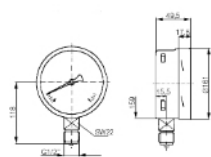

Model P1536



Item number

	P1533 	P1534 	P1536 
Pressure range bar	Ø100	Ø100 freestanding	Ø160
-0.6... 0	P1533B015001	P1534B015901	P1536B015001
-1... 0	P1533B016001	P1534B016001	P1536B016001
-1... 0.6	P1533B042001	P1534B042901	P1536B042001
1... 1.5	P1533B043001	P1534B043901	P1536B043001
-1... 3	P1533B044001	P1534B044901	P1536B044001
-1... 5	P1533B045001	P1534B045901	P1536B045001
-1... 9	P1533B046001	P1534B046901	P1536B046001
-1... 15	P1533B049001	P1534B049901	P1536B049001
0... 0.6	P1533B067001	P1534B067001	P1536B067001
0... 1	P1533B069001	P1534B069001	P1536B069001
0... 1.6	P1533B070001	P1534B070001	P1536B070001
0... 2.5	P1533B072001	P1534B072001	P1536B072001
0... 4	P1533B073001	P1534B073001	P1536B073001
0... 6	P1533B074001	P1534B074001	P1536B074001
0... 10	P1533B075001	P1534B075001	P1536B075001
0... 16	P1533B076001	P1534B076001	P1536B076001
0... 25	P1533B078001	P1534B078001	P1536B078001
0... 40	P1533B079001	P1534B079001	P1536B079001
0... 60	P1533B080001	P1534B080001	P1536B080001
0... 100	P1533B081001	P1534B081001	P1536B081001
0... 160	P1533B082001	P1534B082001	P1536B082001
0... 250	P1533B084001	P1534B084001	P1536B084001
0... 400	P1533B086001	P1534B086001	P1536B086001
0... 600	P1533B087001	P1534B087001	P1536B087001
0... 1000	P1533B088001	P1534B088901	P1536B088001
0... 1600	P1533B089901	P1534B089901	P1536B089901

Special versions

(min. quantity 10 pcs)

- Ø160 mm connection to the rear, model P1531...
- Connection to the rear with panel clamp
- Flange at front, chrome for panel-mounting
- Flange at rear, for bulkhead-mounting
- Pointer adjustable from outside
- Max. pointer (shows maximum deflection)
- Alternative scales
- Alternative connections