

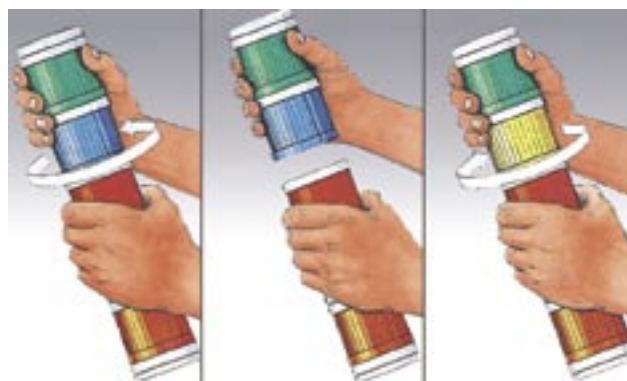

Features

- modularly designed, versatile, flexible and powerful signal towers for smaller machines
- any desired combination possibilities for many different kind of applications
- complete range of visual and audible modules in all conventional voltages
- extensive mounting offers
- PLC ft (leakage/inrush current)
- UL certified, Protection class IP 65, UL type 4, 4X, 13

modul contacts



- modular construction with bayonet locking system
- fast and easy to operate, mount, configure and change of modules
- troublefree and fingersafe bulb change at any position without using any tools



- safety screws for additional safety of modules against unauthorized opening

QUICK MOUNT SYSTEM „FOOT ADAPTER“ (Pat.No. 501053) (Base type VFR)



Quick mounting system “Foot adapter” saves the customer the electrical connection and eases considerably mounting of signal tower for machine manufactures and their customers. Detailed description see page 53.

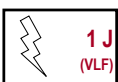
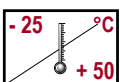

CONFIGURATION

SIGNAL TOWER modulSIGNAL50



LIGHT MODULES	Light source	Type
Steady light	bulb or LED-bulb	VLL
Flashing light		VLB
Strobe light	xenon tube	VLF
PIEZO BUZZER	Sound pressure	Type
Continuous or pulsing tone and sound pressure selectable with DIP switches	88 -103 dB	VDE
Continuous or pulsing tone externally switchable sound pressure selectable with DIP-switch		VDZ



BASES



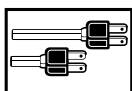

Technical data

for all modulSIGNAL50 modules/products:

Housing material	polycarbonate, grey or black
Lens material	polycarbonate
Lens colours	amber, red, clear, blue, green, yellow

Terminals	up to 2,5 mm ²
Temperature range	-25 °C to +50 °C

Light modules		VLL	VLB	VLF
Bulb		7 W		
Socket BA15d		X		
Flashing-/Strobe frequency			2 Hz	1,4 Hz
Lifetime		~ 10 Mio. flashes		
Strobe energy				1 J
Light emission		360°		
Light type		steady light	flashing l.	strobe light
Leakage		3 mA		
Nominal current	12 V	max. 5 W		110 mA
	24 V	max. 7 W		70 mA
	110/120 V			26 mA
	230/240 V			15 mA
Protection class		IP 65, UL type 4, 4X, 13		
Weight		55 g	60 g	70 g
Weight (Bases)	pls. refer to general weight list on page 156-159			

Buzzer modules		VDE	VDZ
Tone type		continuous and pulsing tone	
Tone frequency		2.800 Hz	
Sound pressure level		88 / 103 dB with DIP-switch selectable	
Leakage		3 mA	
Nominal current	12 V	12 mA	
	24 V	25 mA	
	110/120 V	33 mA	
	230/240 V	33 mA	
Tone selection		DIP-switch	externally switchable
Protection class		IP 65, UL type 4, 4X, 13	
Weight		100 g	

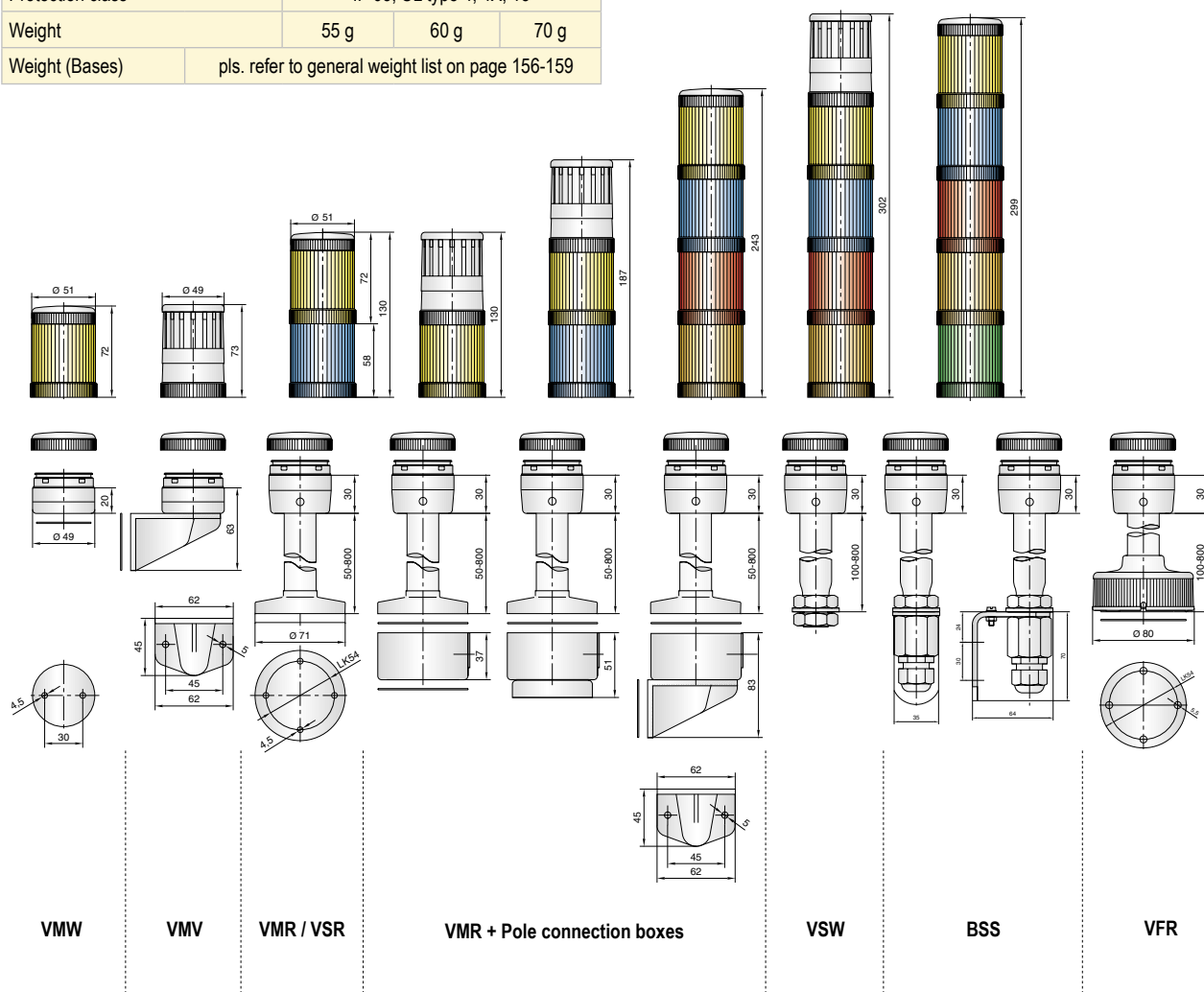

QUICK MOUNT SYSTEM „FOOT ADAPTER“

(Pat.No. 501053) (Base type VFR)

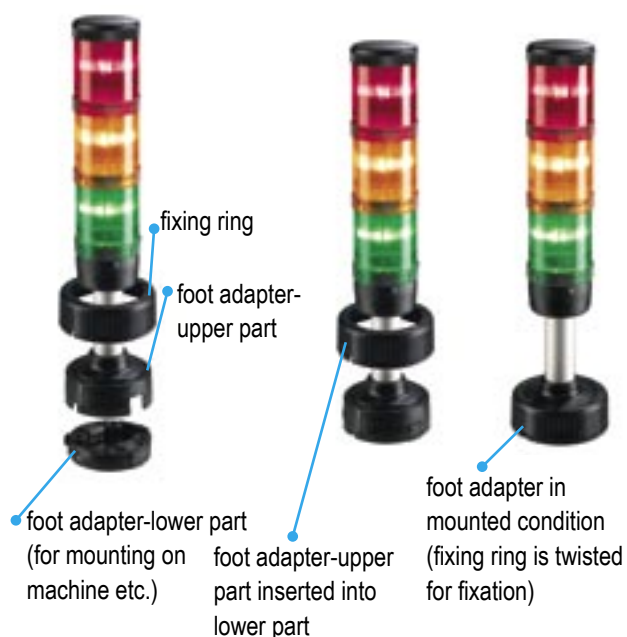

the foot adapter quick mount system also includes a **shipping cover**, which protects the lower part of the foot adapter from dust and environmental influences during transport or storage of the machine.

Function

- the signal tower with pole mount base on aluminium tube with foot adapter for quick mounting (VFR) is electrically pre-wired
- the foot adapter lower part is mounted on the machine etc. and electrically connected
- the signal tower with foot adapter upper part is inserted into the lower part and firmly mounted by twisting the fixing ring
- the signal tower is immediately fully operable

Advantages

- simple and cost saving disassembly of signal tower for transport of machine etc.
- quick cost saving installation of complete signal tower at client
- immediate function, no electrical connection required at client
- safe transport of signal tower (separately packed)
- additional locking option of signal tower with safety screw that cannot be lost
- signal tower fits only in one position onto the foot adapter lower part – no wrong installation of signal tower possible

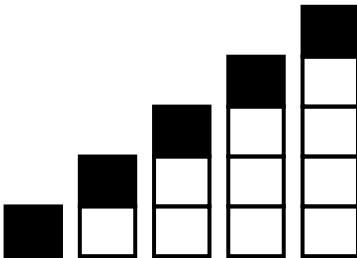

Module combinations

						
Can be used on position	1	2	3	4	5	Remark
Light modules (all types)	OK	OK	OK	OK	OK	to be used in any position
Buzzer-modules, tone type internally switchable	OK	OK	OK	OK	OK	to be used only on top position
Buzzer-modules, tone type externally switchable	OK	OK	OK	OK	-	to be used only on top position



Order data

Type	Light modules	Light options		required positions	Order No.		Nominal voltage (V)
		Bulb	LED-bulb				
VLL	Steady light	GL	LLL, LLB	1	750 00C 900		up to 250 V AC/DC
VLB	Flashing light	GL	LLL	1	760 00C 405		12-24 V AC/DC
					760 00C 310		110/120 V AC
					760 00C 313		230/240 V AC
VLF	Strobe light	xenon tube		1	770 00C 405		12-24 V AC/DC
					770 00C 310		110/120 V AC
					770 00C 313		230/240 V AC
	Piezo Buzzer modules	Tone options			Housing grey	Housing black	
		Tone type	Sound pressure				
VDE	Piezo Buzzer, IP 65 tone type and sound pressure selectable with DIP-switch	continuous/pulsing	88/103 dB	1	781 100 404	781 500 404	12 V AC/DC
					781 100 405	781 500 405	24 V AC/DC
					781 100 310	781 500 310	110/120 V AC
					781 100 313	781 500 313	230/240 V AC
VDZ	Piezo Buzzer, IP 65 tone type externally switchable sound pressure selectable by DIP-switch	continuous/pulsing	88/103 dB	2	782 100 404	782 500 404	12 V AC/DC
					782 100 405	782 500 405	24 V AC/DC
					782 100 310	782 500 310	110/120 V AC
					782 100 313	782 500 313	230/240 V AC
	Bases				Housing grey	Housing black	Weight (g)
VMW	Base for horizontal mounting				790 120 900	790 520 900	45
VMV	Base for vertical mounting				790 140 900	790 540 900	85
VMR	Pole mount base on aluminium tube with plastic foot				790 14L 900	790 54L 900	55-245
VSR	Pole mount base on stainless steel tube with zinc die-cast foot, powder coated				790 15L 900	790 55L 900	205-955
VSW	Pole mount base for horizontal mounting with screw				790 17L 900	790 57L 900	
BSS	Set for vertical mounting (for VSW)				200 400 900	200 800 900	
VFR	Pole mount base on aluminium tube with foot adapter for quick mounting				790 18L 900	790 58L 900	
Cap - is automatically included with each base							

ORDER DATA ACCESSORIES		
Type	Nominal voltage (V)	Order No.
GL01	12 V 5 W	890 010 904
GL02	24 V 7 W	890 010 905
GL03	48 V 7 W	890 010 908
GL04	60 V 7 W	890 010 909
GL05	110/120 V 7 W	890 010 910
GL06	230/240 V 7 W	890 010 913
LED-Bulb BA15d		Steady light
LLL	12 V AC/DC	893 00C 404
	24 V AC/DC	893 00C 405
	48 V AC/DC	893 00C 408
	110/120 V AC	893 00C 310
	230/240 V AC	893 00C 313
		Flashing light
LLB	12 V AC/DC	893 01C 404
	24 V AC/DC	893 01C 405
	48 V AC/DC	893 01C 408
	110/120 V AC	893 01C 310
	230/240 V AC	893 01C 313

ACCESSORY SAFETY SCREWS

- additional safety device of modules against unauthorized opening

Type	AS-Interface	Order No.
	Safety screw set	700 000 900

Colour code for lens

1	amber	5	blue
2	red	6	green
4	clear	7	yellow

Length code for tubes

1	50 mm (not for VFR)	5	500 mm
2	100 mm	6	600 mm
3	250 mm	7	800 mm
4	400 mm		

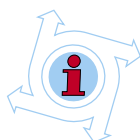

NOTE:

Light sources have to be ordered separately. (pls. refer to order datas- accessories)

ACCESSORIES POLE CONNECTION BOXES

For additional installation possibilities of pole mount assemblies VMR:

- ▶ surface cable conduits in protection class IP 65 – horizontally or vertically
- ▶ model with magnetic base for mobile mounting, signalling device in protection class IP 65 on metal surfaces

BDW



BDM



BDV



Type	Pole connection box	Order No.		Weight (g)
		Housing grey	Housing black	
BDW	for horizontal mounting	841 10T 900	841 50T 900	90
BDV	for vertical mounting	841 11T 900	841 51T 900	110
BDM	for magnetic mounting	841 12T 900	841 52T 900	330

Code for thread

1	M 20	5	PG 16
2	NPT 1/2"		

AS-INTERFACE



AS-Interface implementation possibilities into Auer signal towers modulSIGNAL50 (IP 65)

- ▶ external power supply up to 250 V AC
- ▶ up to 4 of any module with same nominal voltage independently addressable.

Further technical data, drawings and information about AS-Interface please refer to page 142-143.

Type	AS-Interface	Order No.		Weight (g)
		Housing grey	Housing black	
	External power supply:			
AWVMR	AS-Interface pole connection box for horizontal mounting and pole mount base on aluminium tube with plastic foot	790 14L 520	790 54L 520	
AVVMR	AS-Interface pole connection box for vertical mounting and pole mount base on aluminium tube with plastic foot	790 15L 520	790 55L 520	

How to order Signal Tower modulSIGNAL50

Configuration 24 V AC/DC	Position	Type	Order No. Catalogue	correct order no.
Steady light red	3	VLL	750 00C 900	750 002 900
Flashing light amber	2	VLB	760 00C 405	760 001 405
Steady light green	1	VLL	750 00C 900	750 006 900
Pole mount base on aluminium tube with foot adapter for quick mounting, 100 mm long		VFR	790 58L 900	790 582 900
3 x bulb		GL02	890 010 905	890 010 905



Configuration 24 V AC/DC	Position	Type	Order No. Catalogue	correct order no.
Strobe light amber	3	VLF	770 00C 405	770 001 405
Steady light blue	2	VLL	750 00C 900	750 006 900
Steady light red	1	VLL	750 00C 900	750 002 900
Pole mount base on aluminium tube for horizontal mounting with screw, 250 mm long		VSW	790 57L 900	790 573 900
2 x bulb		GL02	890 010 905	890 010 905



Configuration 230 V AC	Position	Type	Order No. Catalogue	correct order no.
Buzzer-module	4 / 3	VDZ	782 100 313	782 100 313
LED-steady light green	2	VLL	750 00C 900	750 006 900
LED-Bulb green		LLL	893 00C 313	893 006 313
LED-flashing light red	1	VLL	750 00C 900	750 002 900
LED-Bulb red		LLB	893 01C 313	893 012 313
Base for vertical mounting		VMV	790 140 900	790 140 900

